

Perfect Brake Job. Every time.

MODELS: • PFM 9.2



**50-033**

## ● **Redesigned PFM 9.2 BELT COVER** **Change effective with serial # 9LX20379**

### WHAT IS IT?

In our old age we've become just a bit more modest! That's one way of looking at this change to a completely redesigned belt cover. In an attempt to rectify fit issues; perception of quality of cog gears/belts as seen through the old clear belt cover; and difficulty in obtaining a straight view of the serial number in a dark shop; we've redesigned the belt cover using a solid black textured ABS plastic material and new structural design. Due to the manufacturing process, this new cover requires a different attachment method. The new cover uses 3 small aluminum stand offs held in place by small o-rings onto 3 button headed screws.

### INSTALLATION INSTRUCTIONS

Send bolt through front of cover and place an aluminum stand off on the bolt followed by an o-ring to hold the stand off in place while you install the cover. Repeat twice more or until all bolts are through and have stand off and o-ring on them. Carefully center each bolt in its corresponding hole and tighten securely. The stand offs limit the amount the screw can go in and keep the screws from being over tightened.

### SERIAL NUMBER LOCATION CHANGES

For everyone's convenience, there are now two locations for the serial number. The first will be located on the micro-switch and is designed primarily for the shipping dept. to identify lathes easily. Although this location is only stuck on, the adhesive is fairly strong and may stay in place quite some time. The second and most permanent location is on the underside of the lathe between the gear box and the clutch handle (hockey puck) and will be held in place by a rivet.

**Contact the Pro-Cut Service Department  
with any questions: 800-543-6618.**

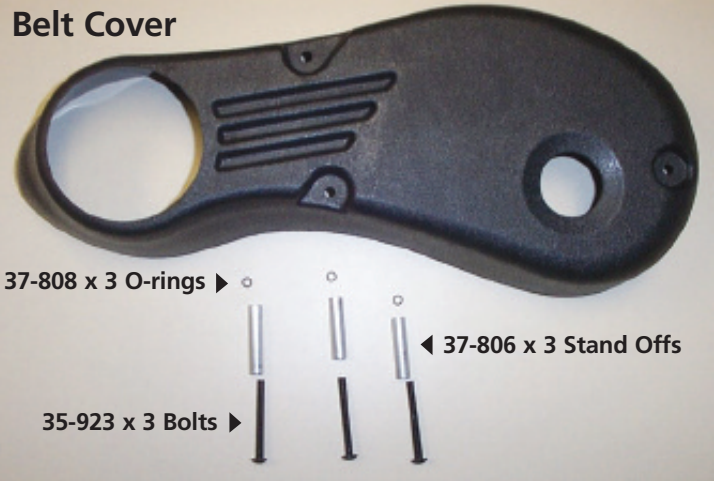

▶ New temporary shipping location for serial number on micro-switch

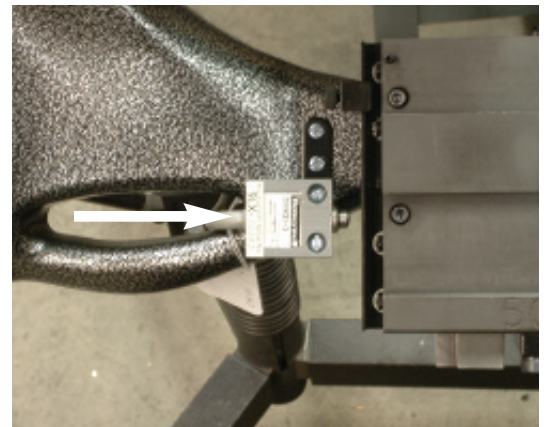

▶ New permanent serial number location underneath lathe

